

**LEGEND**

- DIRECTION OF TRAVEL
- $(x')$  TRAVEL DISTANCE TO EXIT
- EXIT LIGHT
- EMERGENCY LIGHT

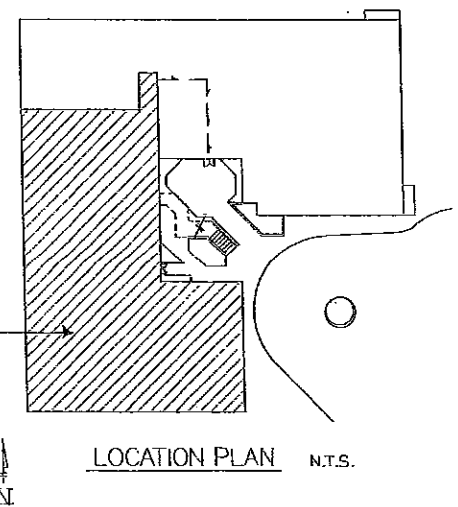

**LIFE-SAFETY PLAN** 1/4"=1'-0"

N

ALL INFORMATION PER FLORIDA BUILDING CODE  
2007 EDITION  
N.F.P.A. 101 LIFE SAFETY CODE 2006 EDITION

**EXIT CALCULATIONS**

GROSS AREA: 1,425 SQ. FT.

OCCUPANT LOAD: 1 PERSON / 100 GROSS SQ. FT.  
1,425 / 100 = 15 PEOPLE

REQUIRED EXIT WIDTH: (2) (15) = 3' OF REQUIRED EXIT WIDTH

TOTAL EXIT WIDTH SHOWN: 72"

**BUILDING INFORMATION**

EXISTING BUILDING IS A TYPE II-B UNSPRINKLERED  
UNPROTECTED FOR A GROUP "B" OCCUPANCY

\* MAXIMUM ALLOWABLE TRAVEL DISTANCE PER TABLE 1016.1 = 200'

REVISIONS



Florida reg. no. AR0004684  
ncarb no. 10591



LARRY W. ROBINSON, P.E.  
414 North Halifax Avenue  
Daytona Beach, Florida 32118  
Telephone 386-252-0429  
Fax 386-252-0523  
e-mail larry@lwr.com

PROPOSED RENOVATIONS  
FOR THE OFFICES OF V.C.O.G./M.P.O.  
AT INDIGO PROFESSIONAL CENTER  
2570 INT'L. SPEEDWAY BLVD. DAYTONA BEACH, FL.

DATE: MARCH 5, 2010

COMPL. NO.

DRAWN BY: T.S.H.

SHEET TITLE: LIFE-SAFETY PLAN

SHEET: A-3

OF 3