



Florida Department of Transportation

RICK SCOTT
GOVERNOR

719 S. Woodland Boulevard
DeLand, FL 32720-6834

JIM BOXOLD
SECRETARY

August 12, 2015

Subject: US 92 (International Speedway Boulevard) Pedestrian Improvements Design-Build
From Williamson Boulevard to Midway Avenue
Volusia County, Florida
New Pedestrian Bridge Installation- Upcoming US 92 Detour
Financial Project ID Number: 434871-1-52-01

Dear Stakeholder,

The new pedestrian bridge installation is scheduled from 10 p.m. to 5 a.m. Tuesday, Aug. 18. During the installation, US 92 (International Speedway Boulevard) will be closed – eastbound and westbound – between Daytona Boulevard and Bill France Boulevard.

Well-marked detours will be in place. Maps and graphics of the detour are attached for your reference.

Detours:

- Traffic going eastbound on US 92 will turn left on to Daytona Boulevard, right on to Avenue B, and then right on to Bill France Boulevard, where US 92 eastbound can be accessed.
- Traffic going westbound on US 92 will turn right on to Bill France Boulevard, left on to Avenue B, left on to Industrial Parkway, right on to Avenue A, and left on to West Road, where US 92 westbound can be accessed

All businesses within the construction zone will be accessible during the installation of the pedestrian bridge.

If you have any questions, please do not hesitate to contact me at 386-740-3519 or by email at Bradley.Bauknecht@dot.state.fl.us. You may also contact Katie Widdison, Public Involvement Coordinator, at 386-212-0449 or by email at Katie.Widdison@dot.state.fl.us.

For more information about this, and all Central Florida state roadway projects, visit www.cflroads.com.

Sincerely,

Bradley Bauknecht
FDOT Project Manager

Westbound US 92 Detour

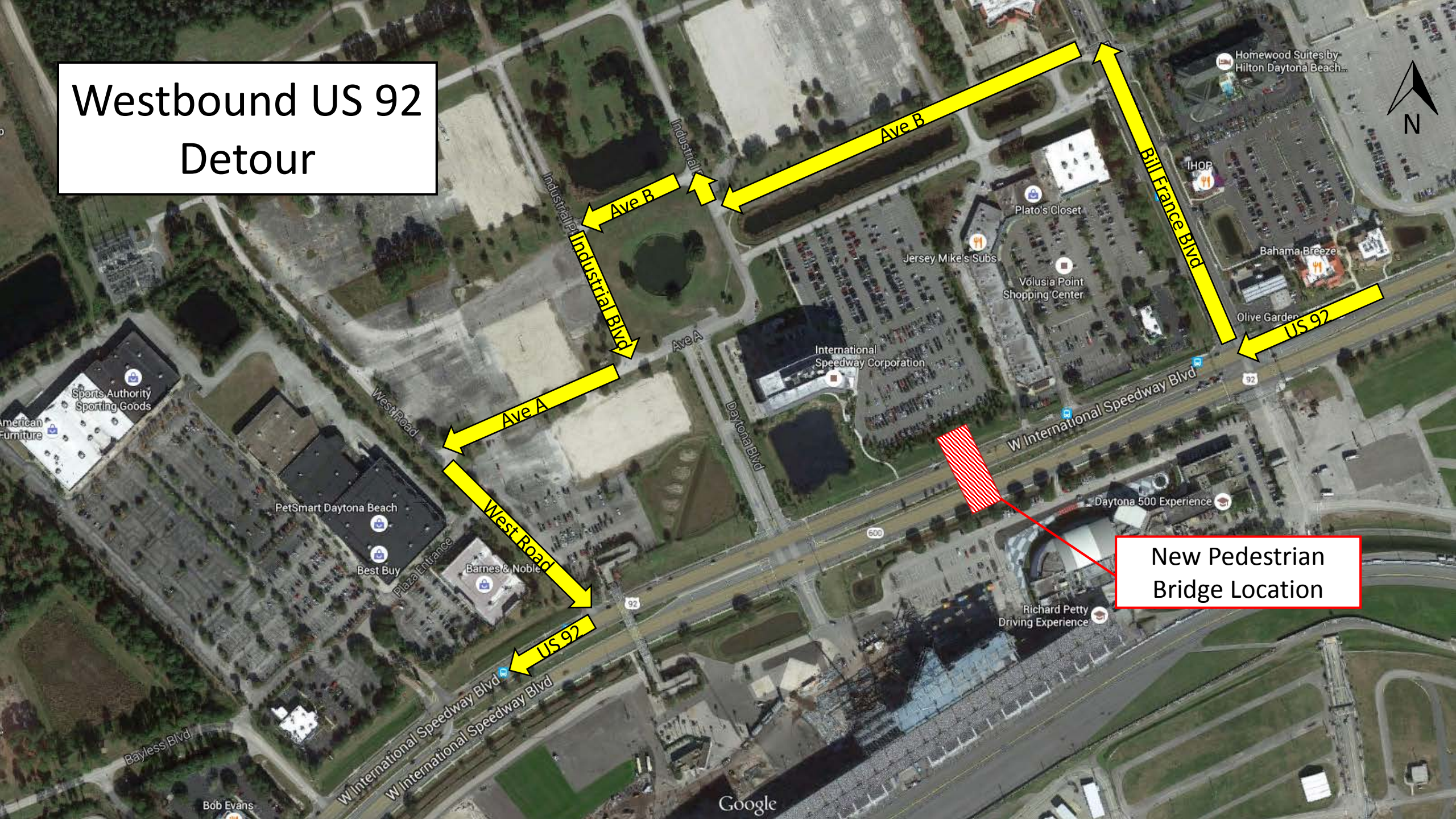

New Pedestrian
Bridge Location

Westbound US 92
Detour

Ave B

Industrial Blvd

Ave A

West Road

US 92

Ave B

Bill France Blvd

US 92

Sports Authority
Sporting Goods

PetSmart Daytona Beach

Best Buy

Barnes & Noble

International
Speedway Corporation

Plato's Closet

Jersey Mike's Subs

Volusia Point
Shopping Center

IHOP

Bahama Breeze

Olive Garden

W International
Speedway Blvd

Daytona 500 Experience

Richard Petty
Driving Experience

Google

Bob Evans

Bayless Blvd

W International
Speedway Blvd

Eastbound US 92 Detour



New Pedestrian
Bridge Location



Eastbound US 92
Detour

Sports Authority
Sporting Goods

PetSmart Daytona Beach

Best Buy

Barnes & Noble

International
Speedway Corporation

Plato's Closet

Jersey Mike's Subs

Volusia Point
Shopping Center

Homewood Suites by
Hilton Daytona Beach...

IHOP

Bahama Breeze

Olive Garden

Daytona 500 Experience

Richard Petty
Driving Experience

Google

92

500

92

US 92

US 92

Ave A

Daytona Blvd

Ave B

Bill France Blvd

US 92

Ave A

Ave B

Industrial Pkwy

Ave B

Industrial Pkwy

West Road

W International Speedway Blvd

W International Speedway Blvd

Bayless Blvd

Bob Evans

American Furniture

Plaza Entrance

W International Speedway Blvd

Daytona 500 Experience

Richard Petty
Driving Experience

Bahama Breeze

IHOP

Plato's Closet

Jersey Mike's Subs

Volusia Point
Shopping Center

International
Speedway Corporation

Ave A

Daytona Blvd

Ave B

Bill France Blvd

US 92

92

500

92

US 92

US 92

Ave A

Daytona Blvd

Ave B

Bill France Blvd

US 92

Ave A

Ave B

Industrial Pkwy

Ave B

Industrial Pkwy

West Road

W International Speedway Blvd

W International Speedway Blvd

Bayless Blvd

Bob Evans

American Furniture

Plaza Entrance

W International Speedway Blvd

Daytona 500 Experience

Richard Petty
Driving Experience

Bahama Breeze

IHOP

Plato's Closet

Jersey Mike's Subs

Volusia Point
Shopping Center

International
Speedway Corporation

Ave A

Daytona Blvd

Ave B

Bill France Blvd

US 92

92

500

92

US 92

US 92

Ave A

Daytona Blvd

Ave B

Bill France Blvd

US 92

Ave A

Ave B

Industrial Pkwy

Ave B

Industrial Pkwy

West Road

W International Speedway Blvd

W International Speedway Blvd

Bayless Blvd

Bob Evans

American Furniture

Plaza Entrance

W International Speedway Blvd

Daytona 500 Experience

Richard Petty
Driving Experience

Bahama Breeze

IHOP

Plato's Closet

Jersey Mike's Subs

Volusia Point
Shopping Center

International
Speedway Corporation

Ave A

Daytona Blvd

Ave B

Bill France Blvd

US 92

92

500

92

US 92

US 92

Ave A

Daytona Blvd

Ave B

Bill France Blvd

US 92

Ave A

Ave B

Industrial Pkwy

Ave B

Industrial Pkwy

West Road

W International Speedway Blvd

W International Speedway Blvd

Bayless Blvd

Bob Evans

American Furniture

Plaza Entrance

W International Speedway Blvd

Daytona 500 Experience

Richard Petty
Driving Experience

Bahama Breeze

IHOP

Plato's Closet

Jersey Mike's Subs

Volusia Point
Shopping Center

International
Speedway Corporation

Ave A

Daytona Blvd

Ave B

Bill France Blvd

US 92

92

500

92

US 92

US 92

Ave A

Daytona Blvd

Ave B

Bill France Blvd

US 92

Ave A

Ave B

Industrial Pkwy

Ave B

Industrial Pkwy

West Road

W International Speedway Blvd

W International Speedway Blvd

Bayless Blvd

Bob Evans

American Furniture

Plaza Entrance

W International Speedway Blvd

Daytona 500 Experience

Richard Petty
Driving Experience

Bahama Breeze

IHOP

Plato's Closet

Jersey Mike's Subs

Volusia Point
Shopping Center

International
Speedway Corporation

Ave A

Daytona Blvd

Ave B

Bill France Blvd

US 92

92

500

92

US 92

US 92

Ave A

Daytona Blvd

Ave B

Bill France Blvd

US 92

Ave A

Ave B

Industrial Pkwy

Ave B

Industrial Pkwy

West Road

W International Speedway Blvd

W International Speedway Blvd

Bayless Blvd

Bob Evans

American Furniture

Plaza Entrance

W International Speedway Blvd

Daytona 500 Experience

Richard Petty
Driving Experience

Bahama Breeze

IHOP

Plato's Closet

Jersey Mike's Subs

Volusia Point
Shopping Center

International
Speedway Corporation

Ave A

Daytona Blvd

Ave B

Bill France Blvd

US 92

92

500

92

US 92

US 92

Ave A

Daytona Blvd

Ave B

Bill France Blvd

US 92

Ave A

Ave B

Industrial Pkwy

Ave B

Industrial Pkwy

West Road

W International Speedway Blvd

W International Speedway Blvd

Bayless Blvd

Bob Evans

American Furniture

Plaza Entrance

W International Speedway Blvd

Daytona 500 Experience

Richard Petty
Driving Experience

Bahama Breeze

IHOP

Plato's Closet

Jersey Mike's Subs

Volusia Point
Shopping Center

International
Speedway Corporation

Ave A

Daytona Blvd

Ave B

Bill France Blvd

US 92

92

500

92

US 92

US 92

Ave A

Daytona Blvd

Ave B

Bill France Blvd

US 92

Ave A

Ave B

Industrial Pkwy

Ave B

Industrial Pkwy

West Road

W International Speedway Blvd

W International Speedway Blvd

Bayless Blvd

Bob Evans

American Furniture

Plaza Entrance

W International Speedway Blvd

Daytona 500 Experience

Richard Petty
Driving Experience

Bahama Breeze

IHOP

Plato's Closet

Jersey Mike's Subs

Volusia Point
Shopping Center

International
Speedway Corporation

Ave A

Daytona Blvd

Ave B

Bill France Blvd

US 92

92

500

92

US 92

US 92

Ave A

Daytona Blvd

Ave B

Bill France Blvd

US 92

Ave A

Ave B

Industrial Pkwy

Ave B

Industrial Pkwy

West Road

W International Speedway Blvd

W International Speedway Blvd

Bayless Blvd

Bob Evans

American Furniture

Plaza Entrance

W International Speedway Blvd

Daytona 500 Experience

Richard Petty
Driving Experience

Bahama Breeze

IHOP

Plato's Closet

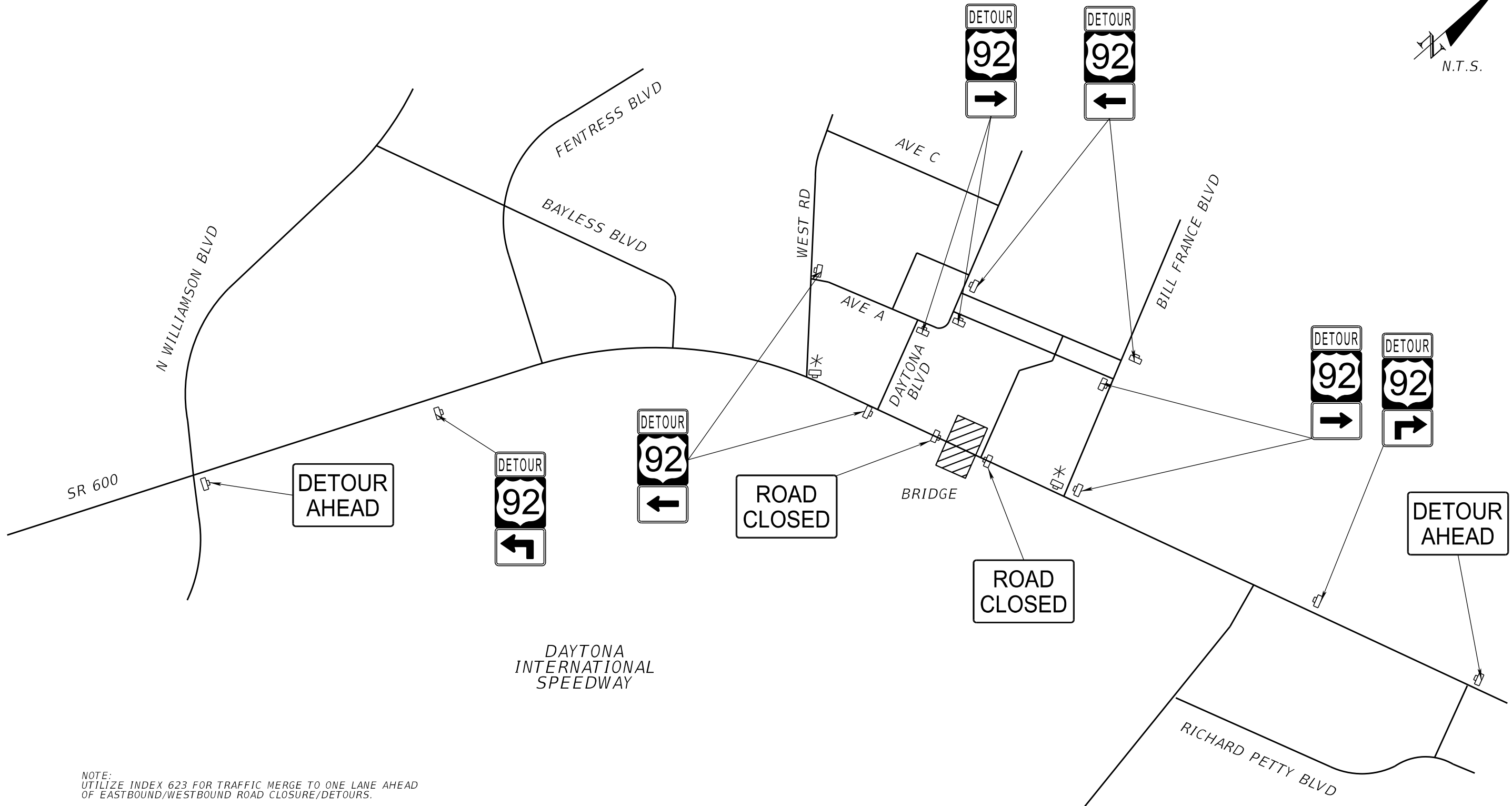
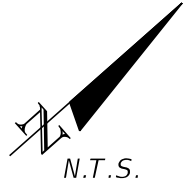

* END
DETOUR

NOTE:
UTILIZE INDEX 623 FOR TRAFFIC MERGE TO ONE LANE AHEAD
OF EASTBOUND/WESTBOUND ROAD CLOSURE/DETOURS.

REVISIONS				RONALD F. HOOGLAND, P.E. P.E. LICENSE NUMBER 45247 GAI CONSULTANTS, INC. 1301 RIVERPLACE BLVD - SUITE 900 JACKSONVILLE, FL 32207 CERTIFICATE OF AUTHORIZATION 9951	STATE OF FLORIDA DEPARTMENT OF TRANSPORTATION			TRAFFIC CONTROL PLANS DETOUR	SHEET NO. 108
DATE	DESCRIPTION	DATE	DESCRIPTION		ROAD NO.	COUNTY	FINANCIAL PROJECT ID		
8/11/15	2 REVISED DETOUR ROUTE			600	VOLUSIA	434871-1-52-01			